



## DT 100 and DT 100 FP

Both the DT 100 and DT 100 FP terminals are well suited to be deployed for all time & attendance applications. Up to 2,000 credential records can be stored in the terminal's internal memory.

Thanks to its compact construction profile, the terminal can fit into almost any location.

The ergonomic foil keypad has clear function symbols and a reassuring confirmatory click. Individual time data such as arrivals, departures, overtime, etc. can be queried at the terminal. This is also possible in offline mode. The 2 line, 16 digit LCD display offers backlighting and a very clear resolution.

These reliable terminals have been designed for a long service life and contain no moving parts. As a result, service costs are reduced to an absolute minimum.

### DT 100 FP

The DT 100 FP has been specially developed to meet the requirements of applications where additional safeguards using biometric identification are also called for.

Thanks to its robust and compact construction, the state-of-the-art optical fingerprint sensor is particularly well-suited for high levels of daily use. The surface of the optical sensor is practically scratch-resistant making the terminal suitable for almost all applications.

This robust high-end product offers the possibility of storing up to 6,000 fingerprint templates in one unit, for fingerprint identification (1:n) or fingerprint verification (1:1).

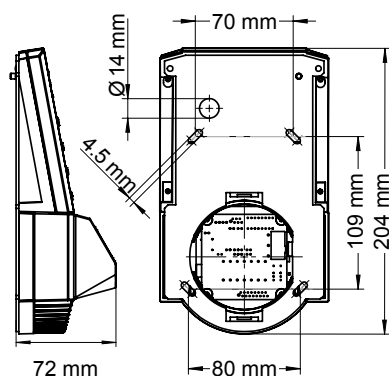
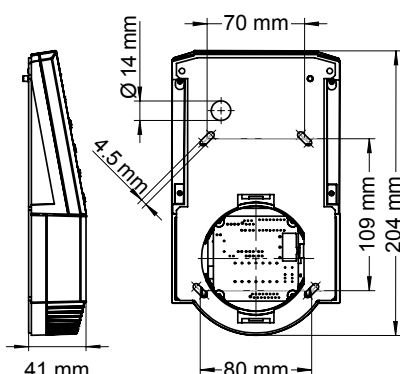

## Features

- ▶ Buffer for at least 1,700 offline booking events
- ▶ Dialogue query in online and offline mode
- ▶ 8 freely selectable records in off-line mode
- ▶ Keys can be activated / deactivated on an employee record basis
- ▶ 8 freely programmable keys for query and dialogue functions
- ▶ System parameter for business absence key (arrive / depart with reason)
- ▶ Door opener function using integrated release relay
- ▶ Integrated RDT functions
- ▶ Optional Ethernet interface
- ▶ DES3 encryption with TCP/IP network communications
- ▶ Available with numerical keypad for code input as an option

### Additional DT 100 FP features

- ▶ Optical fingerprint sensor
- ▶ Fingerprint identification/verification for up to 3,000 persons

made in

**Germany**

## Technical data

<b>Power supply</b>	9 - 15 VDC, typically 12 VDC
<b>Power consumption</b>	Typically 6 W (at 12 VDC)
<b>PoE Class PD</b> , in accordance with IEEE 802.3af	3 (optional, requires F627-000.01)
<b>Housing</b>	Impact resistant synthetic material
<b>Colour</b>	Front — Light grey, RAL 7035
	Rear — Traffic grey, RAL 7042
<b>Weight</b>	Typically 1.0 kg (FP: typically 1.1 kg)
<b>Protection class</b>	IP30
<b>Host interface</b>	RS232 and RS485, optional Ethernet (see accessories)
<b>Read technologies</b>	Credential only — MIFARE® DESFire®, LEGIC advant® or HITAG*
	Fingerprint identification — Fingerprint sensor
	Fingerprint verification — Fingerprint sensor + MIFARE classic®
<b>Biometrics</b>	Optical sensor
<b>Display</b>	2 x 16 digit LCD
<b>Keypad</b>	8 key foil keypad (alternative 16 key number pad)
<b>Fingerprint template access times</b>	with 500 persons 1.0 - 1.6 s with 3,000 persons 1.4 - 1.9 s

This device fulfils the specifications of DIN EN 60721-3-3:1995/A2:1997, Class 3K3,3Z11 (interior)

\* Configurable through jumper settings to EM read technology from the EM Microelectronic-Marin SA company

## Ordering Information

### DT 100 Time & Attendance terminal with function keypad, light grey, max. 2,000 credential records

D211-187.01 ——— MIFARE® DESFire®  
D211-130.01 ——— LEGIC advant®  
D211-157.01 ——— HITAG

### DT 100 Time & Attendance terminal with numeric keypad, light grey, max. 2,000 credential records

D221-187.01 ——— MIFARE® DESFire®  
D221-130.01 ——— LEGIC advant®  
D221-157.01 ——— HITAG

### DT 100 FP Time & Attendance terminal; fingerprint identification with function keypad, light grey

D211-118.01 ——— max. 500 persons  
D211-166.01 ——— max. 3,000 persons

### DT 100 FP Time & Attendance terminal; fingerprint verification with function keypad, light grey

D211-166.99 ——— Fingerprint sensor + MIFARE classic® reader, max. 3,000 persons

### DT 100 accessories

F608-000.01 ——— Ethernet adapter, including power supply with emergency backup power, in surface-mounted design  
F627-000.01 ——— Ethernet adapter with PoE, in surface-mounted design  
Z080-020.01 ——— Power supply with integrated back-up power; Output: 5 VDC / 1 A or 12 VDC / 1.6 A  
Z080-040.01 ——— Pluggable power supply, 9 V / 1 A, with two-pin screw connector  
Z080-100.01 ——— 230 V Power supply with backup power (for surface mounting)  
Z070-060.01 ——— 12 V / 700 mAh battery  
Z140-040.01 ——— Mounting plate  
Z040-070.01 ——— Mounting column. Brushed stainless steel  
Z030-050.01 ——— Privacy and weather-proof housing  
O110-002.01 ——— MSO 300 Enrolment station, for enrolling fingerprints in the database (fingerprint identification)  
O002-001.01 ——— USB coding station, for writing fingerprints to MIFARE classic® cards (fingerprint verification),  
including customer-specific configuration file  
KP04-001.01 ——— Project card for initialising MIFARE® DESFire® readers  
KP01-001.01 ——— Project card for initialising LEGIC advant® readers

